

NOTICE OF DECISION

PLANNING DIVISION
555 LIBERTY ST. SE, RM 305
SALEM, OREGON 97301
PHONE: 503-588-6173
FAX: 503-588-6005



*Si necesita ayuda para comprender esta informacion, por favor
llame
503-588-6173*

ADMINISTRATIVE DECISION - MINOR HISTORIC REVIEW AMENDED

CASE NO. Historic Review Case HIS15-26 / Amanda No. 15-112605-DR

NOTICE OF DECISION DATE: July 31, 2015

REQUEST: Minor Historic Design Review of a proposal to reconstruct the entrance pillars (1906) at Lee Mission Cemetery (1842), individually listed on the National Register of Historic Places, in the PC (Public and Private Cemetery) zone, and located at 2104 D Street NE (Marion County Assessor's Map and Tax Lot number: 073W24CC03500).

APPLICANT: Stephenie Flora for the Lee Mission Cemetery Association

LOCATION: 2104 D Street NE, 97301

CRITERIA: Salem Revised Code (SRC) Chapter 230.060(q)

FINDINGS: The applicant is proposing to reconstruct four pillars at the entry of the Lee Mission Cemetery. The existing entrance pillars adjacent to D Street are in poor condition, and can no longer be repaired. Staff determined that the following standards from SRC 230 are applicable to this project:

230.060. Standards for Historic Contributing Buildings in Public Historic Districts. Modifications to historic contributing buildings or site features in public historic districts shall comply with this section.

(q) Site Features. Replacement or alteration of site features of a historic contributing building and individually listed public historic resources that are identified as significant features on the historic resource inventory, including, but not limited to, driveways, sidewalks, gardens, significant trees, or geological features is allowed, unless the replacement or alteration would materially alter or destroy the features.

(1) Materials. Materials shall duplicate, to the greatest degree possible, the appearance and physical qualities of the original materials. Example: Rhododendron hedge planted during the period of significance is replanted with heritage varieties available during the period of significance.

(2) Design. The design shall reproduce, to the greatest extent possible, the appearance of the original site feature. Example: If the site contains a Lord and Schryver garden, the replacements shall be allowed provided the original design and location of plantings of the historical garden are retained.

FINDINGS

(1) Materials

The applicant is proposing to reconstruct the entrance pillars with in-kind brick and concrete, restoring their original appearance, thereby meeting SRC 230.060(q)(1).

(2) Design.

The applicant is proposing to reconstruct the four 11' high columns at the entrance to the cemetery. Multiple times over the years, the pillars have been repointed, partially coated with stucco and concrete and painted to ensure added protection from the weather and vandalism. The pillars now require complete reconstruction or they are at risk of permanent collapse. The existing pillars will be deconstructed, with as much salvaged material as possible being retained. The existing 1' high footing and concrete base will be retained and the corbelled brick courses of brick at the base will be reconstructed. The brick veneer will be reinstalled throughout the exterior of the newly reconstructed column, and a new pre-cast concrete cap will be installed on the top of the column. The design of the reconstructed columns reproduces, to the greatest extent possible, the appearance of the original entrance columns, thereby meeting SRC 230.060(q)(2).

DECISION: Based upon the application materials deemed complete on, July 29, 2015, and the findings as presented in this report, the application is **APPROVED**.



Kimberli Fitzgerald, Historic Preservation Officer

kfitzgerald@cityofsalem.net; Phone: 503-540-2397

Application Deemed Complete: July 29, 2015
Notice of Decision Mailing Date: July 31, 2015
Decision Effective: August 18, 2015
State Mandated Decision Date: November 26, 2015

The rights granted by this decision must be exercised by August 18, 2017, or this approval shall be null and void.







This decision is final unless written appeal from an aggrieved party is filed with the City of Salem Planning Division, Room 305, 555 Liberty Street SE, Salem OR 97301, **no later than 5:00 p.m., August 17, 2015**.

The appeal must state where the decision failed to conform to the provisions of the historic preservation ordinance (SRC Chapter 230). The appeal must be filed in duplicate with the City of Salem Planning Division. The appeal fee must be paid at the time of filing. If the appeal is untimely and/or lacks the proper fee, the appeal will be rejected. The Salem Historic Landmarks Commission will review the appeal at a public hearing. After the hearing, the Historic Landmarks Commission may amend, rescind, or affirm the action, or refer the matter to staff for additional information.

Vicinity Map 2104 D St NE



Legend

-  Taxlots
-  Urban Growth Boundary
-  City Limits
-  Outside Salem City Limits
-  Historic District
-  Schools
-  Parks

City of Salem
AT YOUR SERVICE
Community Development Dept.

0 100 200 400 Feet



This product is provided as is, without warranty. In no event is the City of Salem liable for damages from the use of this product. This product is subject to license and copyright limitations and further distribution or resale is prohibited.









PIILARS

piilars

STREET

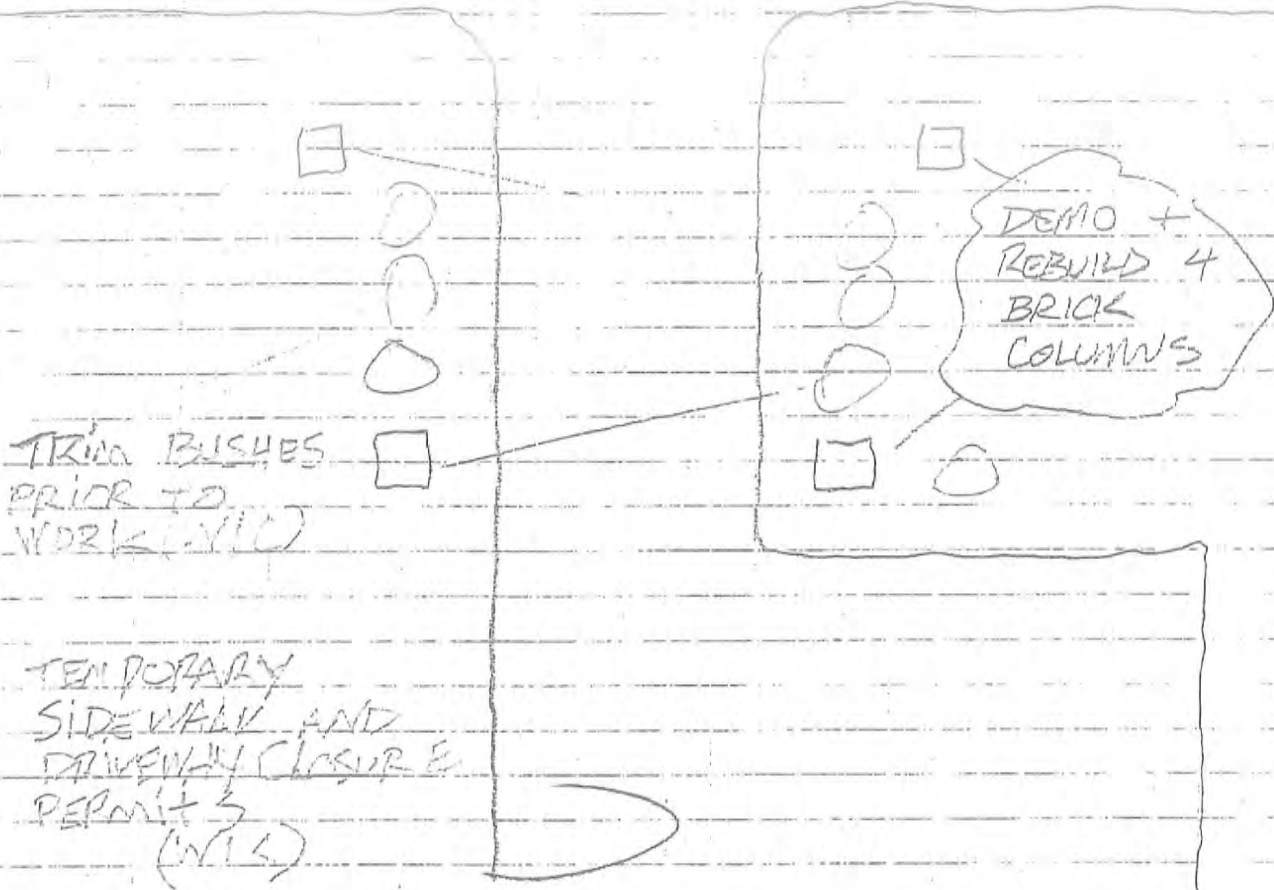

TRIM BUSHES
PRIOR TO
WORK (VLC)

TEMPORARY
SIDEWALK AND
DRIVEWAY CLOSURE
PERMITS
(VLC)

DEMO +
REBUILD 4
BRICK
COLUMNS

↑
NORTH

SK-1

15 113442 BP

2104 D ST NE
REMOVE AND REPLACE COLUMNS AT
"D" ST ENTRY (Reconstruction of entry
pillars)

503 507 4-10-10

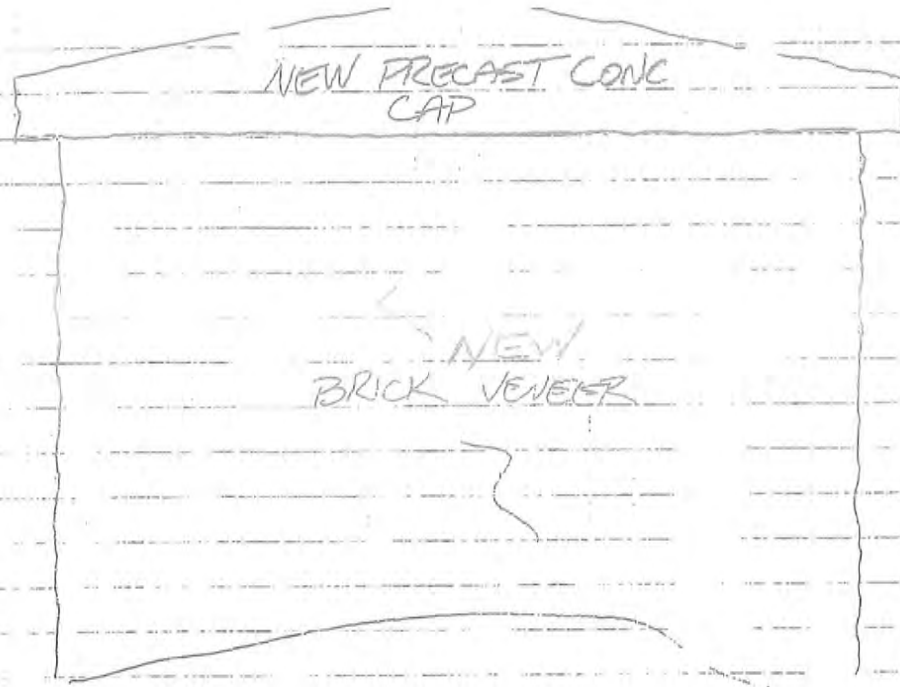

~~± 11~~
11

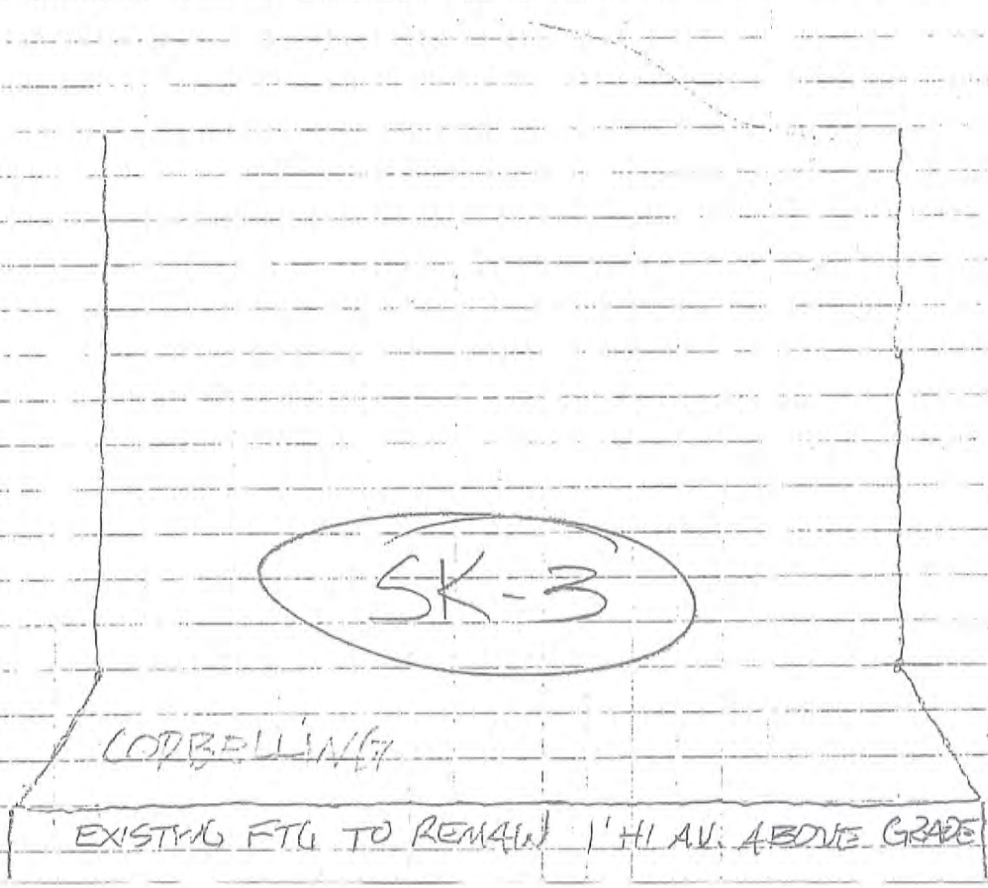

CORBELLING

SK-3

EXISTING FTG TO REMAIN 1' HI. AV. ABOVE GRADE

EXISTING
FTG REMAINS

8" CMU
GRADED SOLID

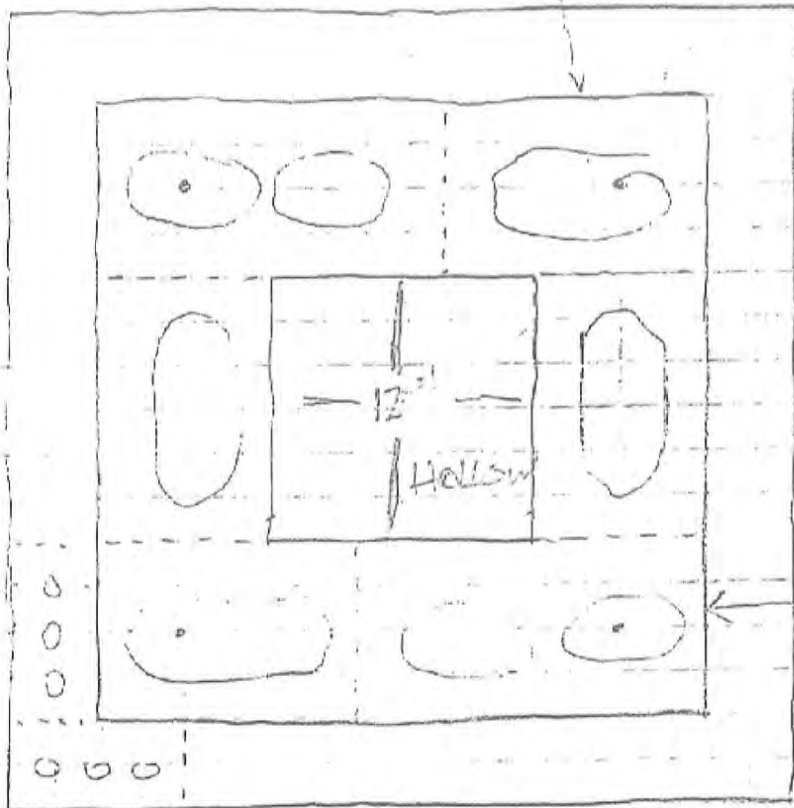

DOWEL + EPOXY
#4 VERT
EA. CORNER

#4 CONTAINMENT
RINGS 16" OC
HORIZ.

← ALTERNATE COURSING

SCORED COURSES OF BRICK @ BASE

BRICK VENEER

WALL / HB 213-0 PLATE
TIES / HB 300 SH 2X DITTEL
ACCEPTS #9 WIRE

SK-2