

EXISTING RIM OR BLOCKING W/OENAILS

SIMPSON A34 @ 16" O.C NAILED TO RIM AND TOP PLATE OF CRIPPLE WALL W/8d NAILS

NEW 2X BLOCKING W/(4) 10d NAILS EACH BLOCK TO SILL

EXISTING FLOOR DECK

EXISTING FLOOR JOISTS PARALLEL TO FOUNDATION

EXISTING CRIPPLE WALL W/1 5/32 OSB W/8d @ 6" O.C EDGES AND 12" O.C FIELD INSIDE FACE

EXISTING MUD SILL W/1/2"ØX4" EMBED SIMPSON TITEN HD (SEE SCHEDULE FOR SPACING) OR EXPANSION ANCHOR WITH WASHER AND NUT

EXISTING FOUNDATION

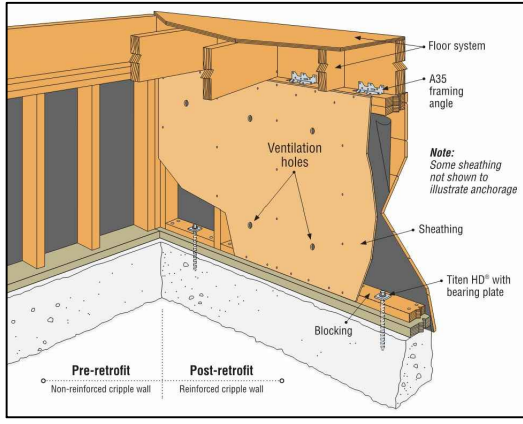

NUMBER OF STORIES	SPACING
SINGLE STORY	5'-0" ON CENTER
TWO STORY	4'-0" ON CENTER

CRIPPLE WALL BRACING WITH WOOD STRUCTURAL PANEL ON INTERIOR FACE/PARALLEL FRAMING



CITY OF SALEM
COMMUNITY DEVELOPMENT DEPARTMENT
BUILDING AND SAFETY DIVISION

555 LIBERTY STREET SE ROOM 320
SALEM OREGON 97301-3513
TEL: (503) 588-6256

STANDARD DETAIL

**FOUNDATION WITH CRIPPLE WALL
PANEL ON INTERIOR FACE**

SILL PLATE/MUDSILL ANCHORED TO FOUNDATION
USING SIMPSON TITAN SCREWS

Revised:	Number
Project No.:	
Date:	
Scale:	